

AJG-M636 Series 140W-155W Multi-Crystalline Photovoltaic Modules

Electrical Performance @ STC^{*1}

Maximum Power	Pmax[Wp]	140	145	150	155
Power Tolerance ^{*2}		+/-3%	+/-3%	+/-3%	+/-3%
Solar Cell Type		Multi-crystalline 6" (156 x 156 mm)			
Number of Solar Cells		36 (6 x 6)			
Maximum Power Voltage	Vmp[V]	17.75	18.06	18.31	18.66
Maximum Power Current	Imp[A]	7.89	8.03	8.19	8.31
Open Circuit Voltage	Voc[V]	22.31	22.53	22.71	23.01
Short Circuit Current	Isc[A]	8.37	8.58	8.81	8.98
Module Efficiency	[%]	14.4%	14.9%	15.4%	15.9%

*1 STC: Irradiance level 1000 W/m²; Spectral AM1.5; Temperature 25°C

*2 Power tolerance can be adjusted upon requests

*3 NOCT: 46±2°C

IV Curve

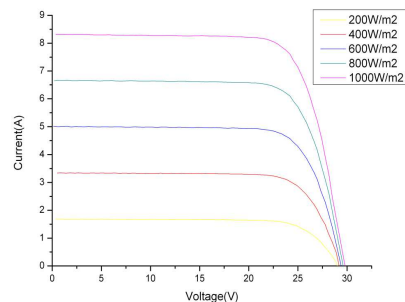

Mechanical Characteristics

Dimensions of the Module (W×H×D)(mm)	1474X660X35
Weight of the Module(kg)	12
Junction box	IP 65/ IP 67 or above with 3 bypass diodes ; cables 1M/φ 4mm ²
Series fuse rating Inside Junction Box	15A

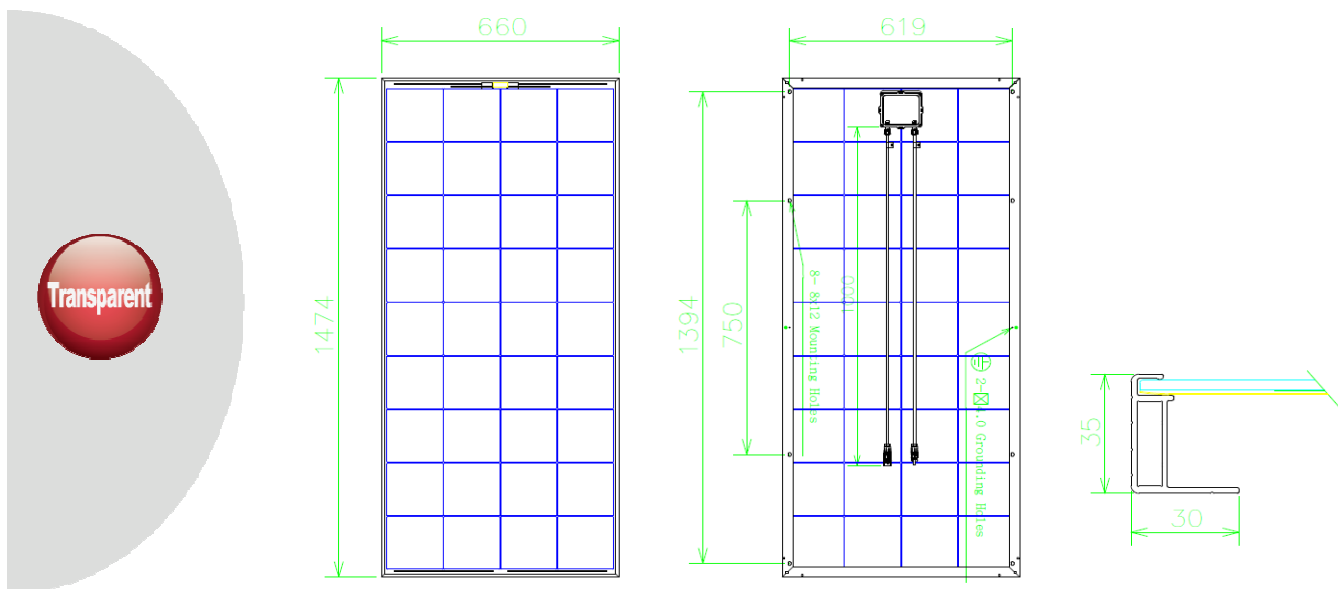

Warranty

Product Warranty:
5 years for material and workmanship

Performance Guarantee:

90% for 10 years Guaranteed output
80% for 25 years Guaranteed output

Working Condition

Maximum System Voltage: 600V, 1000V
Operating Temperature: -40 ~ 85°C
Maximum Static Load: Snow load 5400pa
Wind load 2400pa

Temperature Coefficient

Isc Temperature Coefficient: α(%/°C) +0.08
Voc Temperature Coefficient: β(%/°C) -0.34
Pmax Temperature Coefficient: γ(%/°C) -0.43

Certificate



EN 61215
EN 61730-1
EN 61730-2



Intertek

Anji Technology Co., LTD

No.21 Keji 5th Road, Annan District, Tainan 709, Taiwan
Tel: +886 6 5105988 Fax: +886 6 510 5989

E-mail: service@anjitek.com

* Specification are subject to change without notice

web-link: www.anjitek.com

